

**2017**

**Kit Graduate School Program**

**Introduction**

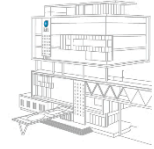



## 1. Vision and Specialization

Since the foundation in 1980 as a university specialized in engineering, kit has cultivated practical and creative engineering talents necessary for the development of national industry. To make a big push, kit has been committed to the growth of students, faculty members, regional communities, and national scientific technology through the advanced curriculum and education programs. Kit has been recognized for having infinite potential for growth, a high-quality practical education system, and a high postgraduate employment rate.

Therefore we are going to elevate our status as the most powerful national engineering university by developing scientific technology and multifunctional talents, leading the industry academy cooperative research based on challenging and creative spirits, and becoming a global (global+local) university with regional communities.

Future education should focus on nurturing creative talented individuals and contributing to the development of regional communities. To this end, universities have to make innovations in the fields of education, research, and cooperation of academy and business. Matching the changes in universities, kit changes the education system to develop sufficient experience based self-directed engineers, and strengthens the foundation for developing regional community and the nation by training multifunctional talents with right personality and leadership.

## 2. Location and Address

61 Daehak-ro, Gumi, Gyeongbuk, South Korea

90 mins from Seoul (Capital) to Gumi by express train, 3 hours by express bus

City of Gumi

- Population: 420,000
- Business Composition: Electronic products 84%, Machinery 4%, Plastics 4%, others 8%
- Exports: USD 34.4 Billion
- Industrial Area: 41km<sup>2</sup> (existing 24.4km<sup>2</sup>, additional 16.6km<sup>2</sup>)
- Labor Pool: 100,025

### Korea's largest national industrial complex

population of 420,000

- A total of **2,005** businesses moved in.
- Export : **5.7%** nationwide
- Trade surplus: **41%**
- Annual gross production of Gumi hits **48 trillion won.**

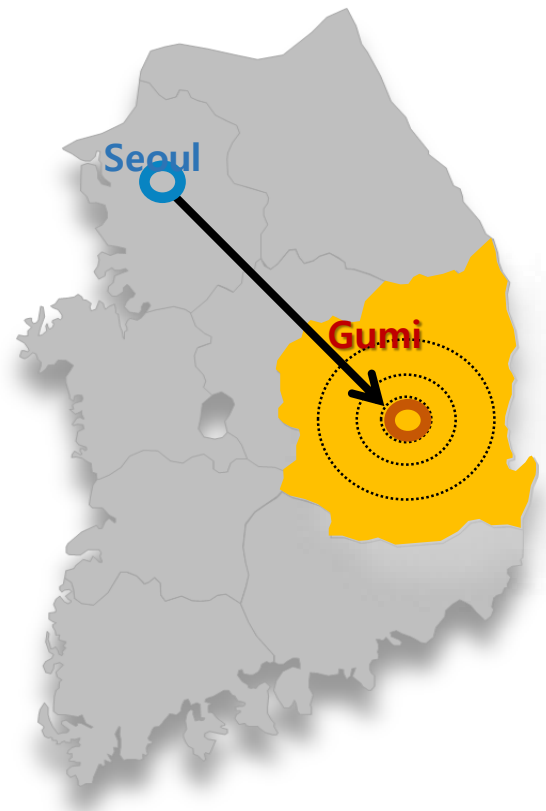
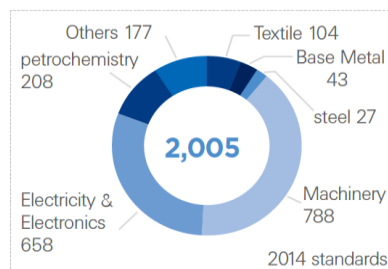

LG



Hanwha



## CONTACT DETAILS & PROGRAMS WE OFFER



### International Office Crews

Eugene Park	Hyejin Kim	Sungmi Lee	Minah Kim
Senior Coordinator	Senior Coordinator	Coordinator	Coordinator
			
eugene@kumoh.ac.kr eugenepark.kit@gmail.com	hjkim@kumoh.ac.kr	sungmi@kumoh.ac.kr	minah@kumoh.ac.kr
+82-54-478-7223	+82-54-478-7215	+82-54-478-7221	+82-54-478-7216
Graduate School Program GKS Program	Korean Language Program	Student Exchange Program	Undergraduate School Program

University webpage <http://eng.kumoh.ac.kr>

Facebook <https://www.facebook.com/kit.intl>

<https://facebook.com/groups/kit.intl>

### Programs we offer

- √ [degree] Undergraduate School Program for International Students
- √ [degree] Graduate School Program for International Students
- √ [degree] Dual Degree Programs for Undergraduate and Graduate School
- √ [non-degree] Korean Language Program for International Students
- √ [non-degree] Student Exchange (Mobility) Programs for International Students
- √ [non-degree] Kit Summer International Camp for 1 or 2 weeks during every August

## DEPARTMENT/MAJOR WE OFFER



Degree	Department	Doctoral /combined degree	Master's	Quota
Engineering	Mechanical Engineering	O	O	unlimited
Engineering	Mechanical System Engineering	O	O	unlimited
Engineering	Mechanical Design Engineering	O	O	unlimited
Engineering	Electronic Engineering	O	O	unlimited
Engineering	IT Convergence Engineering	O	O	unlimited
Engineering	Computer Engineering	O	O	unlimited
Engineering	Software Engineering	O	O	unlimited
Engineering	Architectural Engineering	O	O	unlimited
Engineering	Civil Engineering	O	O	unlimited
Engineering	Environmental Engineering	O	O	unlimited
Engineering	Industrial Engineering	O	O	unlimited
Engineering	Materials Science and Engineering	O	O	unlimited
Engineering	Polymer Science and Engineering	O	O	unlimited
Engineering	Materials Design Engineering	O	O	unlimited
Engineering	Energy and Chemical Engineering	O	O	unlimited
Engineering	Medical IT Convergence Engineering	O	O	unlimited
Engineering	Optical Engineering	n/a	O	unlimited
Natural Sciences	Mathematics	O	O	unlimited
Natural Sciences	Physics	O	n/a	unlimited
Natural Sciences	Applied Chemistry	O	O	unlimited
Business Administration	Business Administration	O	O	unlimited

Tip!) When you apply for Graduate School admission, please make sure to (be assigned by) contact any future supervisor professor you want to work for. Matching the Graduate School applicant and supervisor is very important for the admission stage.

It is important to be fully prepared for your studies before entering kit, so please make sure to contact your future supervisor about any questions or concerns regarding your study plan or the study environment before application. You can access the contact information for all faculty members of kit through the kit English webpage.

# 2017 ACADEMIC CALENDAR & HOLIDAYS



## Academic Calendar

### Spring(1<sup>st</sup>) Semester

Course registration	Feb 13 to 16
Dormitory opening	Feb 24
Orientation	Mar 2
Semester begins	Mar 2
Course change period ends	Mar 13 to 15
Spring festival	May 17 to 19
Final exam	June 14 to 20
End of spring semester	June 21
Dormitory move-out	June 21
Summer vacation	June 22 to Aug 31

### Fall(2<sup>nd</sup>) Semester

Course registration	Aug 31 to Sep 1
Dormitory opening	Aug 30
Orientation	Sep 1
Semester begins	Sep 1
Course evaluation	Nov 21 to Dec 8
Final exam	Dec 11 to 15
End of fall semester	Dec 17
Dormitory move-out	Dec 17
Winter vacation	Dec 18 to Feb 28

## National Holidays

Lunar New Year's Day	Jan 27 to 30
Buddha's Birthday	May 3
Children's Day	May 5
School Foundation Day	May 22
Memorial's Day	June 6
Independence Day	Aug 15
National Foundation Day	Oct 3
Chuseok (Korean Thanksgiving Day)	Oct 4 to 6
Hangul Proclamation Day	Oct 9
Christmas	Dec 25



## SCHOOL FACILITIES



### Dormitory (on-campus housing)

- Single room(very small number of vacancies), double room, quad room are available.
- International students can choose 5 days meal(per week) option, 7 days meal options or no meal option.
- In dormitory cafeteria, only Korean food will be served (lots of pork and spicy food, no halal food).
- Kitchen for international students is available (need to pay 10,000KRW for deposit and access card)
- Students have to change dormitory room for every semester and every vacation (4 times a year).
- Students staying in dormitory must submit TB test result for every semester and vacation (4 times)
- Each room, we have bed, desk, chair, closet
- dormitory fee (from September 1<sup>st</sup> till December 17<sup>th</sup>, 2017)

Bldg.	Room type	Meal option	2 <sup>nd</sup> semester, 2017		
			Total	Meal fee	Maintenance cost
Pureum 2 (male only)	double	7days	455,850	531,300	987,150
		5days	455,850	429,930	885,780
		no meal	455,850	-	455,850
Pureum 3 (female only)	quad	7days	445,050	531,300	976,350
		5days	445,050	429,930	874,980
		no meal	445,050	-	445,050
Pureum 4 (male only)	quad	7days	445,050	531,300	976,350
		5days	445,050	429,930	874,980
		no meal	445,050	-	445,050
Shinpyeong	double	7days	455,850	531,300	987,150
		5days	455,850	429,930	885,780
		no meal	455,850	-	455,850

### Facilities



### Accommodation (outside of campus)

- Near the campus, there are many real estate agencies which can help you to rent your own apartment.
- There are lots of studio apartments near the campus. (5 mins to campus by foot or bus)
- TV, air conditioner, cooking gas, refrigerator and washing machine are provided in most studio apartments.
- Housing contract has to be done by yourself individually.

### Interfaith Prayer Room

- Inside of kit dormitory, we have interfaith prayer room.  
It is available to all students.



## **Cafeteria**

---

- There are three cafeterias on campus. One cafeteria is located inside the dormitory and is only for dormitory residents. The other two are available to everyone, and serve Korean, Chinese, and western style foods. Prices range from 2,000KRW to 4,500KRW per meal.

## **Café**

---

- A Book café is centrally located on campus and offers hot and cold beverages and snacks at a reasonable price.

## **Bank**

---

- There is a bank (Nonghyup Bank) located on campus. You can open your bank account, exchange currency and transfer currency domestically and overseas at this bank.

## **Convenience Store**

---

- You can purchase daily supplies at one of several convenience stores on campus. Convenience stores are also located in several dormitories.

## **Sports facilities**

---

- Gym, Tennis courts, Ping Pong, Soccer/Football stadium, Futsal stadium, Golf club are all located on campus. Use of some facilities, such as the golf club, require fees.



## **Others**

---

- beauty(hair) shop
- bookstore
- photocopy room
- outdoor concert hall
- free medical center

## VISA PROCESS



Every Graduate School international students must have a D-2 student visa.

Necessary documentation varies country to country.

Here is basic document to be prepared for getting D-2 visa.

The Korean Embassy in each country might ask you to submit additional documents.

Document (English)	Document (Korean)	Prepared by
Passport	여권	students
photo	사진	Students
Visa issuance application	비자발급신청서	Students
Handling fee	수수료	Students
Documents proving the final level of education	최종학력증명서	Students
Documents proving your living expenses	재정능력입증서류	students
Standard certificate of admission	표준입학허가서	kit
Certificate of scholarship (if you are scholar)	장학생 증명서 (장학생일 경우)	kit
Certificate of business registration	사업자 등록증	kit
Certificate of affidavit of financial support (if you have any financial support)	재정보증인 재정보증확인서 (재정보증인이 있을 경우)	Supervisor professor Or other institute
Certificate of tuition payment	등록금 납부 확인서	kit



# PROGRAMS FOR INTERNATIONAL STUDENTS

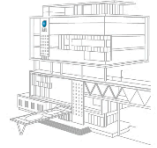

## Free Korean language class

- We open free Korean language classes for all international students.
- Class will start with basic Korean alphabet (hangul 아, 나, 다, 라).
- This is non-credit course.

## Korean buddy program

- We will match one international student and one Korean student. These students will help you to settle yourself in Korea by helping to provide answers to basic questions you may have.

## Voluntary Activity

- You can visit local elementary school, middle school or high school to introduce your own country.
- You will receive certificate for this voluntary activity and small amount of allowance as a reward.



## Activities and field trip

- Every month, we offer various happy activity and field trip for international students

Cooking Day	Making Kimchi Event	Field Trip to Samsung	Chuseok Event
			
Winter Ski Camp	Halloween Day	Temple Stay	Nongshim Factory Tour
			

## PART-TIME WORK

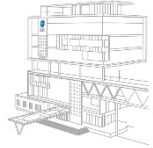

### Part-time work for international students

---

- International students who hold D-2 Visa can have opportunity to do part-time work in Korea during one's study period.
- According to Korean immigration rules and regulations, all international students must report one's part-time work to local immigration office.
- Allowed working hours: Maximum 30 hours per week during semester. Unlimited working hours only during vacation.
- Allowed working places and categories: Translation, serving at restaurant or coffee shops, simple office work assistant (Any kind of teaching, teaching assistant or lecturing activity is strictly prohibited)

### Rules regarding part-time work

---

- Final approval of your work will be made by the officer of immigration office.

If you violate part-time work regulation,

- Found your violation first time: you cannot do part time work for one year
- Found your violation second time: you cannot do part time work for good
- Found your violation third time: your study permit will be canceled for good